

**Generator set**  
**Sound-proof type**  
**WPS625S**

# **SPECIFICATIONS**

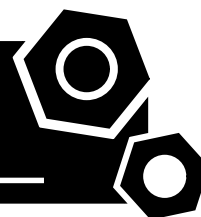

## 1 Standards & Conditions

### Design Standards

The designs and the productions are in conformity with:

- Conformance Européenne (CE)
- China Compulsory Certification (CCC)
- ISO8528-5:2005
- GB/T2820.5-2009

### Environmental Operating Conditions

- Installation place: Outdoors or indoors (well ventilated).
- Ambient temperature: -25°C to 45°C. The coolant heater is needed when the temperature is below 5°C
- Humidity: Less than 80%.
- Altitude: Below one thousand (1000) meters.

### Factory Inspection

- Inspection items.
- Protection devices working test.
- Starting ability in normal temperature.
- 50% rated power load moment capability.
- Voltage deviation and speed variation: 0%, 25%, 50%, 75%, 100%, 110% Load.

### Painting Process

- Painting process specifications and colors are based on the manufacturer's standard.
- The customer could also choose the color which the manufacturer offers.

## 2 General Features

- Perkins engine 2806A-E18TAG2
- Close coupled to a Leroy Somer alternator LSA49.1S4A
- Microprocessor control module PLC-702
- DMA main circuit breaker: 3-Phase 1000A
- Rotate speed governor: Electronic fuel injection governor
- Excitation System: AREP
- A.V.R. Model: R448
- Key switch
- Emergency stop switch
- ATS (automatic transfer switch) receptacle
- 2x12V sealed for life maintenance free battery

- Lockable battery isolator switch
- Powder coated canopy
- 50°C radiator
- Oil pump on the engine
- Steel base frame with forkslots
- Vibration isolators between the engine/alternator and base frame
- Dry type air filter
- Base fuel tank for 7 hours running
- Drain points for fuel tank
- Operation Manual / Specifications

## 3 Equipment Specification

### General technical data

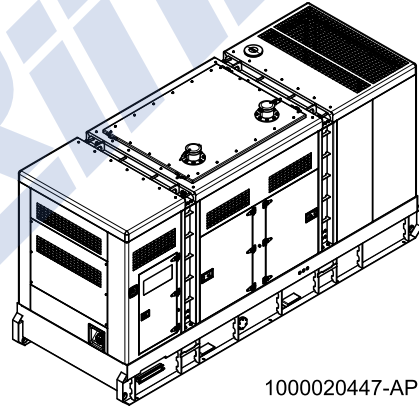

1000020447-AP1-B3

Model.....	WPS625S
Structure type .....	R
Tank capacity.....	945L
Dry weigh.....	6483.6kg
Noise level @7m .....	70.3dB(A)
Dimensions L×W×H.....	4692x1763x2516mm
Standby Power .....	688kVA/550kW
Prime Power .....	625kVA/500kW

Voltage	380V	400V	415V		
Ampere	949.6A	902.1A	869.5A		
Genset Fuel Consumption					
Frequency/Load	25%	50%	75%	100%	110%
50Hz (L/h)	36	65	94	122	136

## Diesel Engine

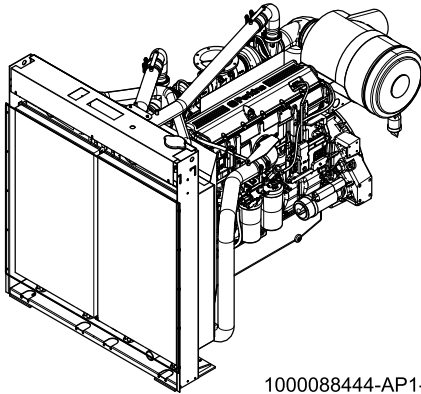

1000088444-AP1-A3

Engine Manufacturer/Brand.....	Perkins
Engine Model.....	2806A-E18TAG2
Dimensions L×W×H.....	2545×1536×1807.5mm
Dry Weigh (approx.).....	2050kg
Number of Cylinders.....	6
Bore.....	145mm
Stroke.....	183mm
Displacement.....	18.13L
Compression Ratio.....	14.5
Type of Injection.....	MEUI
Intake System.....	Turbocharged, air-to-air charge cooled
Intake Resistance.....	≤6.4kPa
Cooling System.....	Water cooled
Fan.....	Pusher
Battery Voltage.....	24V
Type of Fuel.....	BS2869 class A2 or BS EN590
Type of Oil.....	API CG4 or APEA E5
Oil Capacity.....	62L
Type of Coolant.....	Glycol Mixture
Coolant capacity.....	61L
Back Pressure.....	≤6.9kPa
Standby Power.....	628kW
Prime Power.....	584kW
Fuel Consumption(100%load).....	132L/h

## Alternator

1000103173-AP1-A1

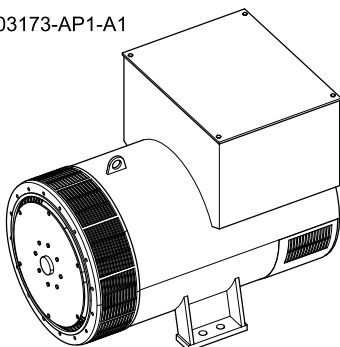

Alternator Manufacturer/Brand.....	Leroy Somer
Alternator Model.....	LSA49.1S4A
Exciter.....	Brushless
Cooling Fan.....	Cast alloy aluminum
Windings.....	100% copper
Insulation Class.....	H
Winding Pitch.....	2/3
Terminals.....	6
Drip Proof.....	IP23
Altitude.....	≤1000m
Overspeed.....	2250rpm
Air Flow.....	1m³/s(50Hz), 1.2m³/s(60Hz)
Voltage Regulation.....	±0.5%
Total harmonic TGH / THC at no load < 4 % - on load < 4 %	
Telephone Interference.....	THF<2%;TIF<50

## PLC-702 Control System

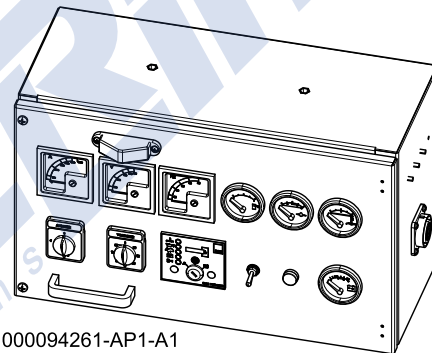

1000094261-AP1-A1

PLC-702 key manual start module is a manual engine control module designed to control the engine via a key switch and push buttons on the front panel. The module is used to start and stop the engine and indicate fault conditions, automatically shutting down the engine and giving a true first up fault condition of an engine failure.

### Standard Control Function

- Manual Engine Control Module
- Low Oil Pressure
- High Engine Temperature
- Auxiliary Shutdown
- Overspeed Protection
- Protection hold-off timer
- Charge Failure warning

## 4 Overall Dimensions

1000020447-DR1-B3

Dry weight	6483.6kg
Fuel tank capacity	945L
Dimensions L x W x H	4692x1763x2516mm

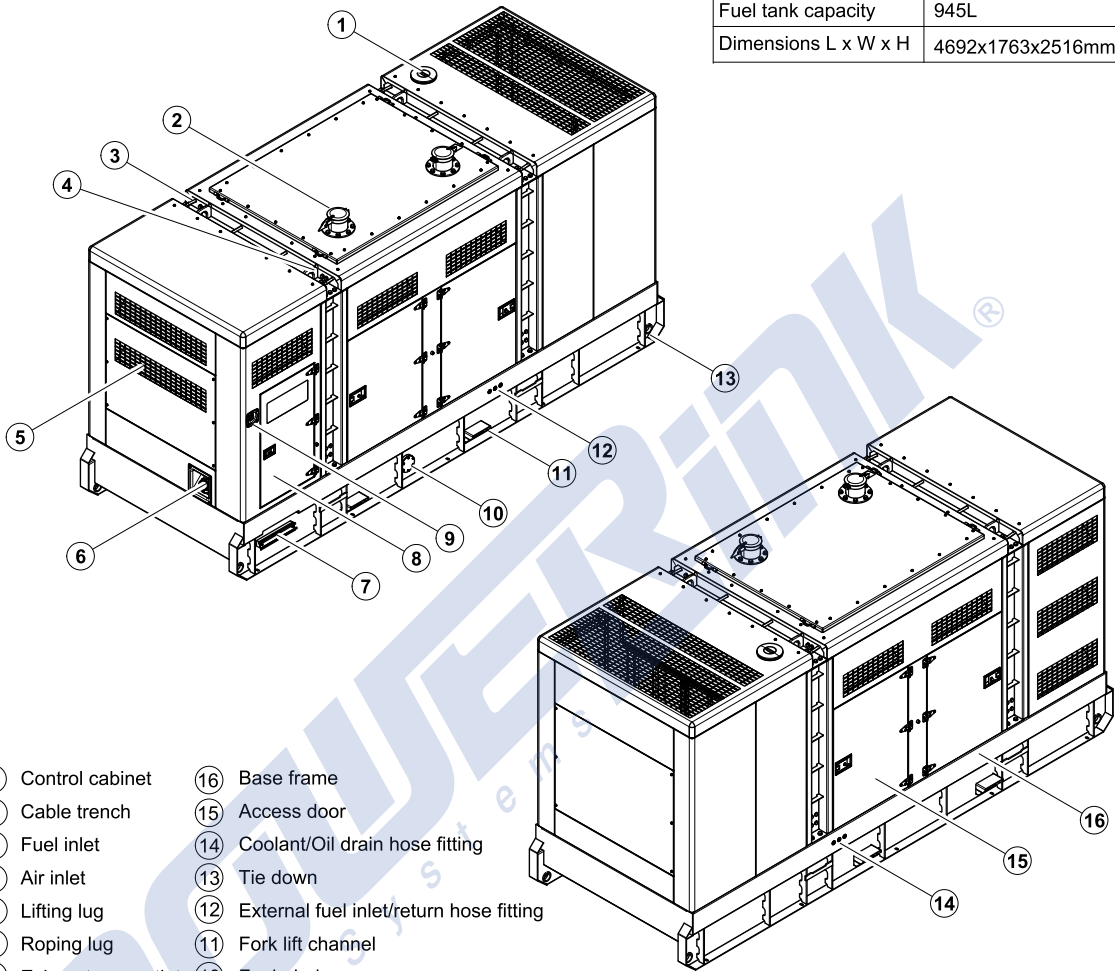

- ⑧ Control cabinet
- ⑦ Cable trench
- ⑥ Fuel inlet
- ⑤ Air inlet
- ④ Lifting lug
- ③ Roping lug
- ② Exhaust gas outlet
- ① Coolant inlet
- ⑩ Fuel drain
- ⑨ Emergency stop switch
- ⑬ Tie down
- ⑫ External fuel inlet/return hose fitting
- ⑪ Fork lift channel
- ⑭ Coolant/Oil drain hose fitting
- ⑮ Access door
- ⑯ Base frame

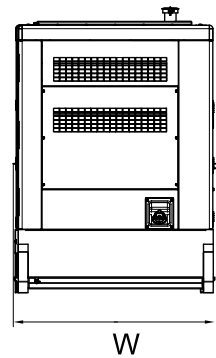
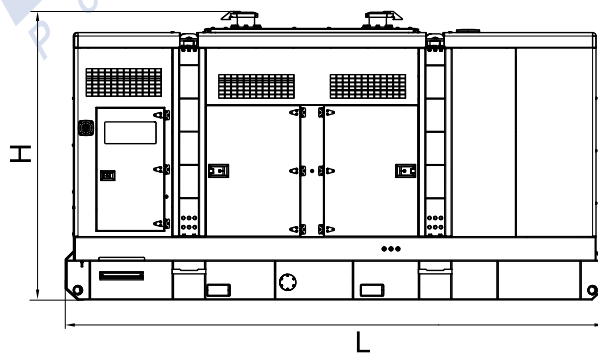

## 5 Control System

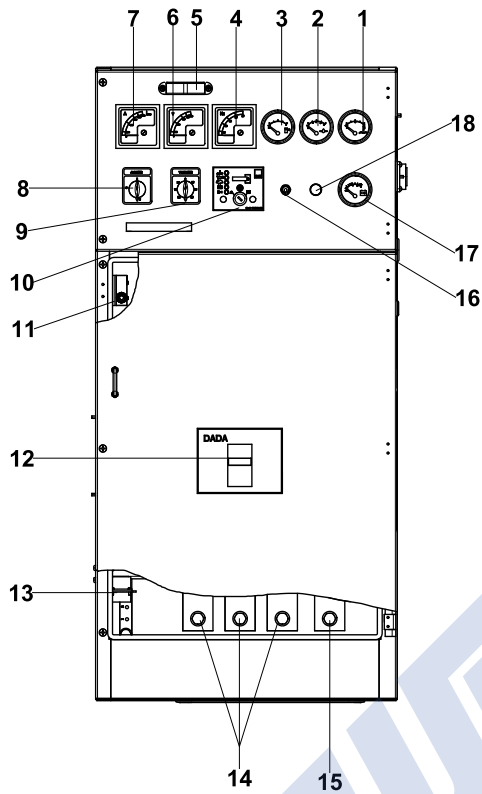

Control & field wiring cabinet

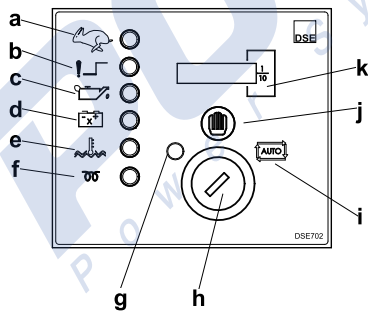

Control panel

Ref.	Description
1	Water temperature meter
2	Oil pressure meter
3	Fuel level meter
4	Frequency meter
5	Control panel lamp
6	Voltage meter
7	Current meter
8	Ammeter change-over switch
9	Voltmeter change-over switch
10	PLC-702 control module
11	Limit switch
12	Main circuit breaker
13	ATS communication interface
14	Live wire terminals
15	Neutral wire terminal
16	Control panel lamp switch
17	Battery voltage meter
18	Charge indicator

a	Over speed protection LED
b	Alarm LED
c	Low oil pressure protection LED
d	Charge failure warning LED
e	High engine temperature protection LED
f	Pre-heat LED
g	Stop model position
h	Control module key switch
i	Auto start position
j	Manual start button
k	Time counter

100020447-B3-E
----------------

05.2012
---------

**POWERLINK**<sup>®</sup>  
Power Systems

<http://www.powerlinkworld.com>

*Specification may change without prior notice. For more info.,  
contact Power Link or your local distributors please.*